



SOUND RATED

JL Industries introduces the first **STC-Rated Access Panel** for walls with an **STC 47 Rating**. The **STC Panel** will help you to meet **noise containment and sound transmission blocking requirements** for walls in new construction or building updates.

- Judicial settings: GSA acoustic isolation ratings
- Learning spaces: Music Rooms, Performing Spaces
- Healthcare: HIPPA Requirements for Patient Privacy
- LEED Enhanced Acoustical Performance Credits for Schools

SOUND RATED: STC™ Series

Frame: 16 Gauge CRS with 1" flange, and continuous gasketing.
Door: 2 1/4" thick with heavy duty, continuous hinge and sound -blocking insulation.
Finish: White powder coat paint.
Latch/Lock: Black compression paddle latch, (2) for heights greater than 30".
STC Rating: 47 when installed as directed in STC-rated wall.
Sizes: Minimum 12"x 12", maximum 24"x 36".

Options: Locking paddle latch, locking or non-locking chrome-plated latch, #4 stainless steel, galvaneal steel, optional paint colors.

Tested in accordance with
 ASTM E90-09
 Sound transmission loss of building partitions.

Classified in accordance with
 ASTM E413-10 Classification for rating sound insulation of partitions or floors.
 ASTM E1223-10a Standard classification for rating indoor/outdoor sound attenuation



Model Size is Door Size			
A - Order Size = Door Size W x H	Wall Opening Dimension (C)	Approx. Weight	Latch(es)
STC-1212	12 3/8"x 12 3/8"	14	1
STC-1414	14 3/8"x 14 3/8"	18	1
STC-1616	16 3/8"x 16 3/8"	23	1
STC-1818	18 3/8"x 18 3/8"	29	1
STC-2030	20 3/8"x 30 3/8"	53	2
STC-2222	22 3/8"x 22 3/8"	40	1
STC-2230	22 3/8" x 30 3/8"	53	2
STC-2236	22 3/8"x 36 3/8"	55	2
STC-2424	24 3/8"x 24 3/8"	46	1
STC-2430	24 3/8"x 30 3/8"	54	2
STC-2436	24 3/8"x 36 3/8"	60	2

Other Sizes up to 24"x 36" in 1/4" Increments Door Size Available



MODEL STC-2436F3



MODEL STC-1212F4
INSULATED AND GASKETED

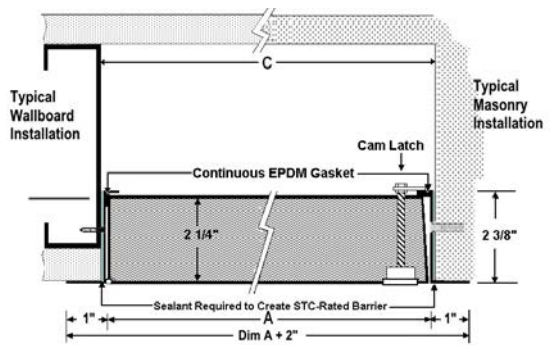

Latch and Lock Options			
Standard Non-Locking Black Latch (F3)	Optional Locking Black Latch (F4)	Optional Non-Locking Chrome Latch (F5)	Optional Locking Chrome Latch (F6)
			



See Our Full Product Offering from Divisions 7, 8, 10, 11, 12, 21 and 23 on Our Website.



CONTACT US | PH: 800-554-6077 | FAX: 952-835-2218

EMAIL: SALES@ACTIVARCPG.COM

HEADQUARTERS: 9702 NEWTON AV SOUTH, BLOOMINGTON, MN 55431

MANUFACTURING: BLOOMINGTON, MN & COMMERCE, CA

WAREHOUSES: DALLAS, TX | LANCASTER, PA | SEATTLE, WA | CHICAGO, IL | FARGO, ND | OMAHA, NE | FT MEYERS, FL

The **Activar Construction Product Group** is a dynamic group of six companies that have combined resources, innovation and experience to serve the commercial construction industry for over 70 years. **Air Louvers** offers a wide variety of metal vision lites & louvers, specialized glass, astragals, and metal edging for both wood and hollow metal doors. **JL Industries, Samson Products** and **Thomas Enterprises** have manufactured and distributed some of the leading lines of fire protection products including a full line of fire extinguishers and cabinets, AEDs and cabinets plus valve and hose cabinets. They also offer rated and non-rated access panels, roof accessories, corner guards, detention products and entrance floor mats & gratings. **RoofTop Accessories** offers safety railings and pipe support systems. **Hiawatha Inc.** provides high-quality architectural door hardware and components.