

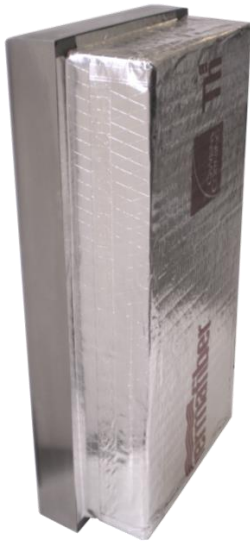

JL INDUSTRIES INTRODUCES THE NEW FIRE-FX2™ FIRE-RATED CABINETS

- ▶ **New UL-Listing**
- ▶ **Lightweight Insulation**
- ▶ **Lower Shipping Costs**
- ▶ **Easier to Install**
- ▶ **Available 2nd Quarter 2015**
- ▶ **Patent Pending**



UL LISTING

Tested to maintain one and two-hour fire-rated wall barriers, in accordance with ANSI/UL-1479 (ASTM E814 and ULC/CAN S115) for membrane and penetration firestops.



1037V10FX

 **Look for the Red FX Symbol in our Fire Protection Catalog!** 

- FIRE-FX2™ for Steel, Aluminum, Stainless Steel, Bronze and Brass Cabinets
- FIRE-FX2™ for All Trim Styles - from Trimless to 4 ½"
- All Recessed Architectural Series Cabinets are Available as Fire-Rated Cabinets
- New FX Wall Openings introduced in January 2015 Accommodate FIRE-FX2™ -
See Website for Updated Catalogs and Submittals with New Wall Openings

1-800-554-6077
SALES@ACTIVARCPG.COM

ACTIVAR
INC.
Construction Products Group

www.activarcpg.com

COMPARE THE WEIGHT OF THE NEW FIRE-FX2 TO THE ORIGINAL FIRE-FX CABINET

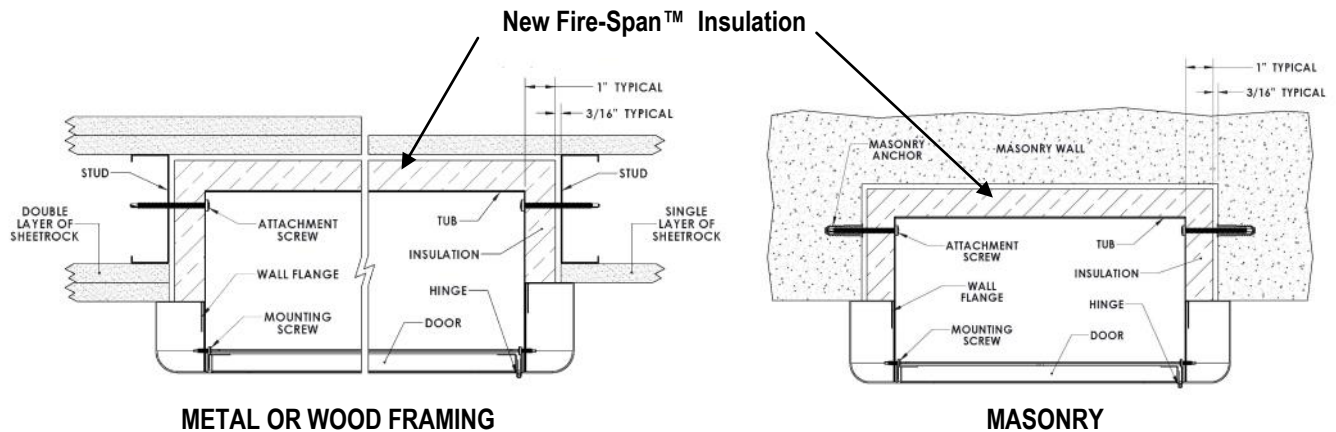

1000, 1800, 1500 Series Cabinets Weigh an average of 14.75 lbs Less!

JL Industries led the industry by introducing the first pre-lined Fire-Rated Cabinets in 1991. Those cabinets have changed and simplified the installation process forever.

Now, JL has taken the next step and eliminated the heavy gypsum wallboard used to line cabinets, by replacing it with lightweight, mineral wool insulation. The second steel tub is not needed with the new design, reducing the weight even more.

FIRE-FX2™ cabinets are insulated with Firespan™ 90 by Thermafiber®, a UL-Listed, inorganic, mineral wool fiber Insulation with a high recycled content.

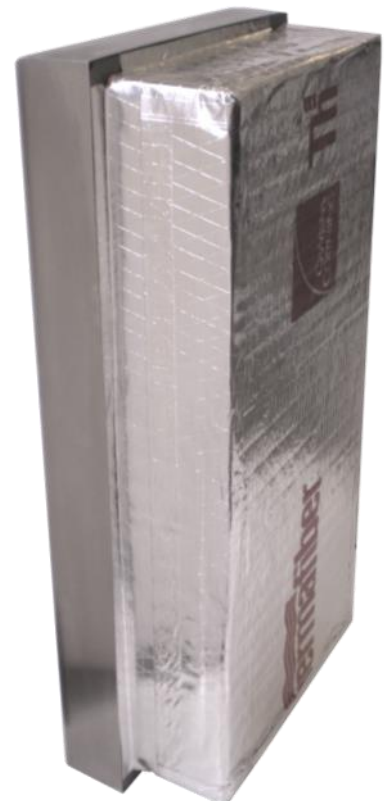

Look for the Red FX2 Symbol in our Fire Protection Catalog!



SEE OUR WEBSITE FOR THE MOST CURRENT INFORMATION - ACTIVARCPG.COM/JL-INDUSTRIES

1-800-554-6077
SALES@ACTIVARCPG.COM

Copyright 2015 Activar
3/21/15



ACTIVAR
INC.
Construction Products Group
www.activarcp.com