

Crownline Cabinets Provide A Wide Selection of Door Styles, Glazing and Sizes. These Durable Cabinets are Designed to Industry This New Version is Designed to be Installed Under the Drywall, for a Flush Finished Sur-

**Door Construction:** Cold rolled steel with white powder-coated finish standard. Flush cabinet doors are attached by a continuous hinge and equipped with zinc-plated handle and roller catch. Doors with glazing have 1-1/4 wide trim.

**Flange Style & Depth:** Trimless Recessed for 5/8" depth drywall or 3/4" depth plaster. First layer of drywall is to be installed before cabinet, second layer over flange after cabinet is installed.

**Tub:** The tub is constructed of cold rolled steel with white powder-coat finish standard. Tub forms a flange to cover cut edges of wallboard material. Fire-resistant material is attached to the exterior of the tub. **Knockouts:** Knockouts are not provided on Fire-Rated Cabinets. Instructions for K.O's in the field are provided, and must be strictly adhered to, to maintain fire rating. Please note that dimensions for wall opening have changed for the new FX2 design. See Chart on pg 2.

**Special Features:** Models 8014 has a shelf 12" from the bottom of the cabinet is designed to hold a fire extinguisher plus FD valve or other accessory. Those models can also be ordered without shelf to allow for lower mounting height of valve piping to meet NFPA10.

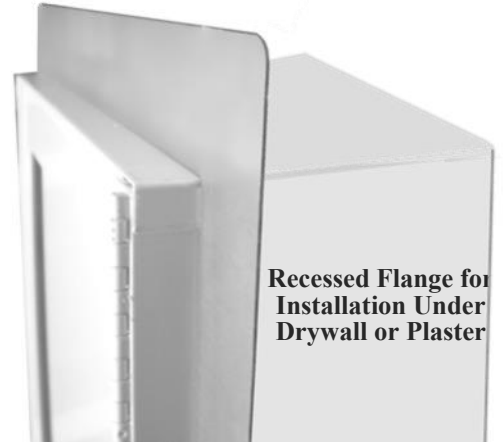

**Recessed Flange for Installation Under Drywall or Plaster**

**Fire-Rating:** Fire-FX2™ cabinets are fabricated in accordance with the UL label for one and two hour combustibile and non-combustibile wall system building codes. The fire testing has met the requirement of ANSI/UL 1479 (ASTM –E814) and ULC/CAN S115-for membrane and penetration firestops. Installation instructions must be strictly adhered to in order to obtain the fire rating.

**STEP 1: SELECT MODEL NUMBER, TRIM & QUANTITY (Refer to Chart on Page 2 )**

**STEP 2: SELECT DOOR STYLE WITH HANDLE** (Check one box below)

- |  |   |
|--|---|
| <input type="checkbox"/> F Full Glazing                          | <input type="checkbox"/> L22 Solid with SAF-T-LOK™                    |
| <input type="checkbox"/> G Full Glazing with SAF-T-LOK™          | <input type="checkbox"/> V Vertical Duo                               |
| <input type="checkbox"/> D Horizontal Duo Panel                  | <input type="checkbox"/> W Vertical Duo with SAF-T-LOK™               |
| <input type="checkbox"/> E Horizontal Dual Panel with SAF-T-LOK™ | <input type="checkbox"/> B10 Solid w/Acrylic View Window & SAF-T-LOK™ |
| <input type="checkbox"/> A Center Duo Panel with SAF-T-LOK™      | <input type="checkbox"/> L24 Solid with Cylinder Lock & No Handle     |
| <input type="checkbox"/> S21 Solid Door                          |   |

[View Door Styles](#)

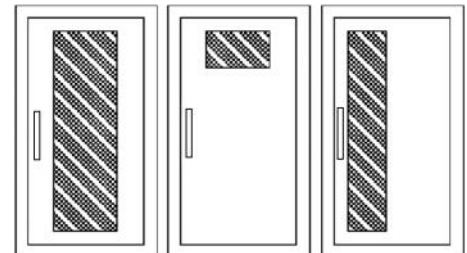

F - Full glass with pull handle  
 D - Horizontal duo panel with pull handle  
 V - Vertical duo panel with pull handle  
 G - Full glass with pull handle & Saf-T-Lok  
 E - Horizontal duo panel with pull handle & Saf-T-Lok  
 W - Vertical duo panel with pull handle & Saf-T-Lok

**STEP 3: SELECT DOOR GLAZING** (Check one box below)

- |   |  |
|---|--|
| <input type="checkbox"/> 10 Clear Acrylic                     | <input type="checkbox"/> 16 Gray Acrylic           |
| <input type="checkbox"/> 13 Clear Wire Glass with Safety Film | <input type="checkbox"/> 17 Clear Tempered Glass   |
| <input type="checkbox"/> 15 Bronze Acrylic                    | <input type="checkbox"/> 18 Laminated Safety Glass |

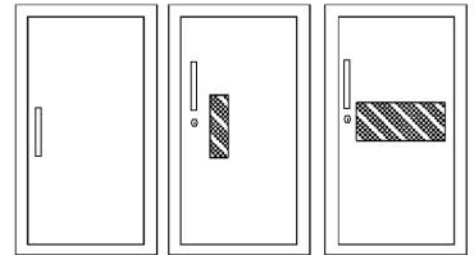

S21 - Solid with pull handle  
 L22 - Solid with pull handle & Saf-T-Lok  
 B - Solid with pull, small view window and Saf-T-Lok  
 A - Center duo panel with pull and Saf-T-Lok

**STEP 4: OPTIONAL FEATURES AT ADDITIONAL COST:**

- |  |   |   |
|--|---|---|
| <input type="checkbox"/> Optional Tub Color: ___ Black ___ Red                   | <input type="checkbox"/> PUF Futura "Fire" Handle                                 | <input type="checkbox"/> Black Vertical FE Letters LDCVBFE                          |
| <input type="checkbox"/> (MC) Magnetic Catch—Replaces Roller Catch               | <input type="checkbox"/> 0710 ADA Flush Pull Handle                               | <input type="checkbox"/> Red Vertical FE Letters LDCVRFE                            |
| <input type="checkbox"/> <u>Optional Color:</u> ___ Red ___ Black ___ Flat Black | <input type="checkbox"/> P6 Polished Chrome Lever Handle                          | <input type="checkbox"/> White Vertical FE Letters LDCVWFE                          |
| ___ Sand ___ AMS Beige ___ SC Flat Beige   | <input type="checkbox"/> FDVO Decal "Fire Dept Valve" Octagonal 6 x 6"            | <input type="checkbox"/> Black Horizontal FE Letters LDCHBFE                        |
| ___ Gray ___ Bronze ___ Silver   | <input type="checkbox"/> 1403 Decal "Fire Hose" Vert. Blk Bkgd, Red Letters 4 x 9 | <input type="checkbox"/> Red Horizontal FE Letters LDCHRFE                          |
| <input type="checkbox"/> CA Commander Alarm                                      | <input type="checkbox"/> LDCHFDV-R Diecut "Fire Dept Valve" Horiz. 10-1/4 x 4-3/8 | <input type="checkbox"/> White Horizontal FE Letters LDCHWFE                        |
| <input type="checkbox"/> BA Brigadier Alarm                                      | <input type="checkbox"/> LDCVRFDV Diecut "Fire Dept Valve" Vert 3/4" x 17"        | <input type="checkbox"/> <a href="#">Etched or Engraved Lettering - Metal/Glass</a> |

For More Options, Visit These Links to Separate Submittals: [Decals & Die Lettering](#), [Alarms](#), [Pulls & Levers](#), [Fire Extinguishers](#), [Fire Hose Racks](#)

<p><b>ACTIVAR INC.</b> CONSTRUCTION PRODUCTS GROUP</p> <p>CROWLINE AND SAF-T-LOK ARE TRADEMARKS OF ACTIVAR PLEASE DOWNLOAD MOST CURRENT SUBMITTAL BEFORE ORDERING</p>	Distributor:	Quantity:
	Contractor:	Approved By:
	Model #:	Architect:
	Project:	Date:
<p><b>Headquarters:</b> 9702 Newton Av S, Bloomington, MN 55431 Ph: 800-554-6077 Fax: 952-835-2218</p> <p><b>Email:</b> sales@activarcpg.com www.activarcpg.com <b>Manufacturing:</b> Bloomington MN &amp; Commerce CA © 2017 Activar Construction Products Group, Inc.</p> <p><b>Warehouses:</b> Ft Myers, FL Dallas TX, Lancaster PA, Atlanta GA, Chicago, IL, Seattle WA, Omaha NE, Fargo ND 8/17/2017</p>		

**SUBMITTAL: CROWLINE™ VALVE & HOSE CABINETS TRIMLESS FX STEEL PG 2 OF 2**

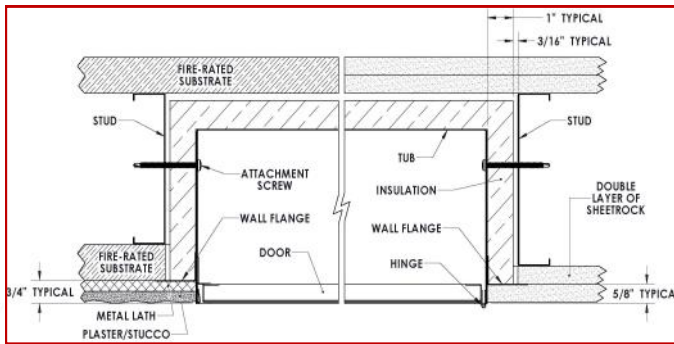
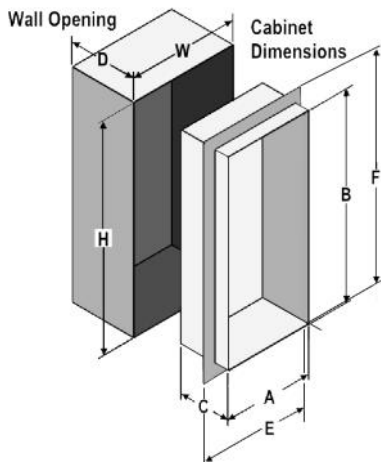

**3/4" PLASTER**

**5/8" DRYWALL**

**ADA Information**

[BIM Objects for REVIT® Platform 8000 Models](#)

[BIM Objects for REVIT® Platform 6000/ 7000 Models](#)

**ADA Cabinet Mounting Height:** Standard Pull on G, E, A, W, L22 and B Door Styles with Saf-T-Lok are 3 5/8" Higher than Door Center, so Allow for that When Mounting Cabinet. Standard Pull with No Lock or ADA Recessed Pull are Centered on Door.

TRIM & DOOR		TUB I.D. W x H x D in Inches			FRAME O.D.		RECESSED WALL OPENING			RECOMMENDED HOSE RACK, VALVES & EXTINGUISHERS
QTY	MODEL #	A Width	B Height	C Depth	E Width	F Height	W Width	H Height	D Depth	
<b>TRIMLESS FX2 CABINET WITH RECESSED FLANGE FOR INSTALLATION OF 5/8" DRYWALL OVER TRIM</b> Example of Part # 8114HF10FX2 Cabinets with Hose Rack & Extinguisher or FD Valve										
	6014H __ FX2	24	30	6	27 1/8	33 1/8	26 5/16	32 5/16	6 11/16	<b>HOSE RACK:</b> 1- 1/2" x 1-1/2" Hose Rack Unit with 50 or 75' Hose (3005, 3105, 3007, 3107) & Cosmic 2½ or Galaxy 2½- 5 lb Extinguisher
	6214H __ FX2	24	34-3/4	6	27 1/8	37 7/8	26 5/16	37 1/16	6 11/16	<b>HOSE RACK:</b> 1- 1/2" x 1-1/2" Hose Rack Unit - 100' Hose (3010 or 3110) & Cosmic 2½ or Galaxy 2½- 5 lb Extinguisher
	6114H __ FX2	24	30	8	27 1/8	33 1/8	26 5/16	32 5/16	8 11/16	<b>HOSE RACK:</b> 2-1/2" x 1-1/2" Hose Rack Unit 50 or 75' Hose (3205, 3207)
	6414H __ FX2	24	34 3/4	8	27 1/8	37 7/8	26 5/16	37 1/16	8 11/16	<b>HOSE RACK:</b> 2-1/2" x 1-1/2" Hose Rack Unit - 100' Hose (3210 Series)
	6614H __ FX2	24	38 3/4	8	27 1/8	41 7/8	26 5/16	41 1/16	8 11/16	<b>HOSE RACK:</b> 2-1/2" x 1-1/2" Hose Rack Unit - 125' Hose (3212 Series)
	6314H __ FX2	30	30	8	33 1/8	33 1/8	32 5/16	32 5/16	8 11/16	<b>HOSE RACK &amp; FD VALVE OR EXTINGUISHER:</b> 1-1/2" OR 2-1/2" Valve 50' or 75' Hose Rack Unit Plus FD Valve or Extinguisher (Not Sentinel 15-20, 272)
	6514H __ FX2	32 3/4	34 3/4	8	35 7/8	37 7/8	35 1/16	37 1/16	8 11/16	<b>HOSE RACK &amp; FD VALVE OR EXTINGUISHER:</b> 1-1/2" OR 2-1/2" Valve, 100' Hose Rack Unit Plus FD Valve or Extinguisher (Not Sentinel 20, 272)
	7214H __ FX2	32 3/4	38 3/4	8	35 7/8	41 7/8	35 1/16	41 1/16	8 11/16	<b>HOSE RACK &amp; FD VALVE OR EXTINGUISHER:</b> 1-1/2" OR 2-1/2" Valve , 125' Hose Rack Unit Plus FD Valve or Extinguisher (Not Sentinel 20, 272)
	8514H __ FX2	18	18	8	21 1/8	21 1/8	20 5/16	20 5/16	8 11/16	<b>FIRE DEPARTMENT VALVE:</b> 1-1/2" or 2-1/2" Fire Department Valve with Cap and Chain
	8414H __ FX2	18	18	10	21 1/8	21 1/8	20 5/16	20 5/16	10 11/16	<b>DUAL SIDE BY SIDE FD VALVES &amp; EXTINGUISHER OR 2 FD VALVES:</b> 1-1/2" or 2-1/2" with Cap and Chain Plus Extinguisher - Cosmic & Galaxy 2-1/2-10, Mercury 2-1/2-11, Grenadier, Saturn 15-25, Sentinel 5
	8714H __ FX2	26	26	8	29 1/8	29 1/8	28 5/16	28 5/16	8 11/16	
	8614H __ FX2	26	26	10	29 1/8	29 1/8	28 5/16	28 5/16	10 11/16	<b>DUAL EXTINGUISHER &amp; FD VALVE CABINET W/ SHELF:</b> Any Extinguisher (Except Sentinel 15-20, & 272)
	8014H __ FX2	16	40	9	19 1/8	43 1/8	18 5/16	42 5/16	9 11/16	
<b>TRIMLESS FX2 CABINET WITH RECESSED FLANGE FOR INSTALLATION OF 3/4" PLASTER OVER TRIM</b> Example of Part # 8114DF10FX2 Cabinets with Hose Rack & Extinguisher or FD Valve										
	6014D __ FX2	24	30	6	27 1/8	33 1/8	26 5/16	32 5/16	6 11/16	<b>HOSE RACK:</b> 1- 1/2" x 1-1/2" Hose Rack Unit with 50 or 75' Hose (3005, 3105, 3007, 3107) & Cosmic 2½ or Galaxy 2½- 5 lb Extinguisher
	6214D __ FX2	24	34-3/4	6	27 1/8	37 7/8	26 5/16	37 1/16	6 11/16	<b>HOSE RACK:</b> 1- 1/2" x 1-1/2" Hose Rack Unit - 100' Hose (3010 or 3110) & Cosmic 2½ or Galaxy 2½- 5 lb Extinguisher
	6114D __ FX2	24	30	8	27 1/8	33 1/8	26 5/16	32 5/16	8 11/16	<b>HOSE RACK:</b> 2-1/2" x 1-1/2" Hose Rack Unit 50 or 75' Hose (3205, 3207)
	6414D __ FX2	24	34 3/4	8	27 1/8	37 7/8	26 5/16	37 1/16	8 11/16	<b>HOSE RACK:</b> 2-1/2" x 1-1/2" Hose Rack Unit - 100' Hose (3210 Series)
	6614D __ FX2	24	38 3/4	8	27 1/8	41 7/8	26 5/16	41 1/16	8 11/16	<b>HOSE RACK:</b> 2-1/2" x 1-1/2" Hose Rack Unit - 125' Hose (3212 Series)
	6314D __ FX2	30	30	8	33 1/8	33 1/8	32 5/16	32 5/16	8 11/16	<b>HOSE RACK &amp; FD VALVE OR EXTINGUISHER:</b> 1-1/2" OR 2-1/2" Valve 50' or 75' Hose Rack Unit Plus FD Valve or Extinguisher (Not Sentinel 15-20, 272)
	6514D __ FX2	32 3/4	34 3/4	8	35 7/8	37 7/8	35 1/16	37 1/16	8 11/16	<b>HOSE RACK &amp; FD VALVE OR EXTINGUISHER:</b> 1-1/2" OR 2-1/2" Valve, 100' Hose Rack Unit Plus FD Valve or Extinguisher (Not Sentinel 20, 272)
	7214D __ FX2	32 3/4	38 3/4	8	35 7/8	41 7/8	35 1/16	41 1/16	8 11/16	<b>HOSE RACK &amp; FD VALVE OR EXTINGUISHER:</b> 1-1/2" OR 2-1/2" Valve , 125' Hose Rack Unit Plus FD Valve or Extinguisher (Not Sentinel 20, 272)
	8514D __ FX2	18	18	8	21 1/8	21 1/8	20 5/16	20 5/16	8 11/16	<b>FIRE DEPARTMENT VALVE:</b> 1-1/2" or 2-1/2" Fire Department Valve with Cap and Chain
	8414D __ FX2	18	18	10	21 1/8	21 1/8	20 5/16	20 5/16	10 11/16	<b>DUAL SIDE BY SIDE FD VALVES &amp; EXTINGUISHER OR 2 FD VALVES:</b> 1-1/2" or 2-1/2" with Cap and Chain Plus Extinguisher - Cosmic & Galaxy 2-1/2-10, Mercury 2-1/2-11, Grenadier, Saturn 15-25, Sentinel 5
	8714D __ FX2	26	26	8	29 1/8	29 1/8	28 5/16	28 5/16	8 11/16	
	8614D __ FX2	26	26	10	29 1/8	29 1/8	28 5/16	28 5/16	10 11/16	<b>DUAL EXTINGUISHER &amp; FD VALVE CABINET W/ SHELF:</b> Any Extinguisher (Except Sentinel 15-20, & 272)
	8014D __ FX2	16	40	9	19 1/8	43 1/8	18 5/16	42 5/16	9 11/16	