

Protect doors from damage from shoes, carts and equipment with durable plates in stainless steel or aluminum. Choose from standard sizes of kickplate, stretcher plate and mop plates or provide us with dimensions for custom sizes.



Bevelled



QTY	MODEL	H X W	EDGES	HOLES	MATERIAL	
	KP08A34A.A10	8" x 34"	Beveled	Countersunk	Stainless Steel	
	KP10A34A.A10	10" x 34"				
	KP08A34A.B10	8" x 34"				
	KP10A34A.B10	10" x 34"				
	KP10A46A.B10	10" x 46"				
	KP34A34A.B10	34" x 34"	Straight	Punched		Stainless Steel
	KP08A34A.F10	8" x 34"				
	KP10A34A.F10	10" x 34"				
	KP10A46A.F10	10" x 46"				
	KP34A34A.F10	34" x 34"				
	KP10A34A.F08	10" x 34"			Aluminum	

AIR LOUVERS

4-30-2025

KICKPLATES - HIAWATHA SERIES - Kick, Armor or Mop Plates - KP

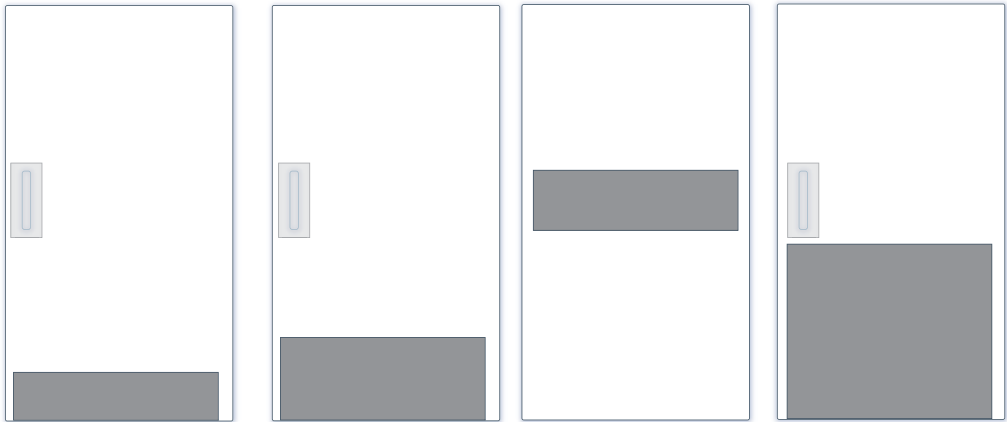

Mop Plate

Up to 8" H x 48" W
ANSI 156.6 J103

Kick Plate

6" to 12" H x 48" W
ANSI 156.6 J102

Stretcher Plate

6" to 12" H x 48" W
ANSI 156.6 J103

Armor Plate

Up to 48" W & H
ANSI 156.6 J101

Screw Quantity Chart

HEIGHT	LENGTH				
	17-½ - 24-½"	25 - 32-½"	33 - 41"	41-½ - 49"	
	4 - 9"	8	10	12	14
	9-½ - 17"	10	12	14	16
	17-½ - 24-½"	12	14	16	18
	25 - 32-½"	14	16	18	20
	33 - 41"	16	18	20	22
	41 - 49"	18	20	22	24

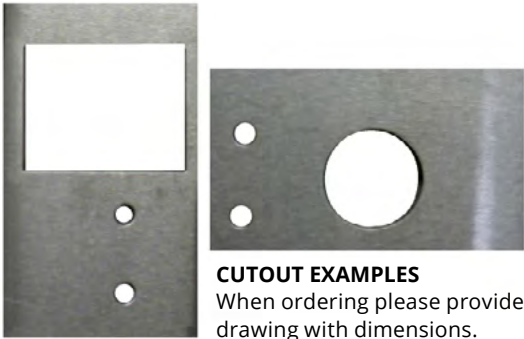

MADE-TO-ORDER KICKPLATES

QTY	HEIGHT	WIDTH	-	FEATURES	MATERIAL	(MATERIAL THICKNESS)	(OTHER OPTIONS)	-	(CUTOUTS)
<input type="text"/>	KP	<input type="text"/>	<input type="text"/>	<input type="text"/>	<input type="text"/>	<input type="text"/>	<input type="text"/>	<input type="text"/>	<input type="text"/>
				F Straight Edges & Punched Holes	08 US28 Clear Anodized Aluminum	(None) .05"	(None)		(None)
				A Beveled Edge & Countersunk Holes	10 US32D Stainless Steel	MA .036"	-B3E Beveled 3 sides		CO Attach drawings
				B Beveled Edge & Punched Holes		MB .06"	T Tape Applied		
				C Straight Edges & Countersunk Holes)		MC .08"	TX Torx Screws		
				D Straight Edges & No Holes)		MD 0.125"	UL* UL Fire-Rated Marking		
				E Beveled Edges & No Holes)					

*Marked on request only
**Optional fire-rating for .036" Stainless steel kickplates with no cutouts can be rated for UL10C for up to 1-½ hours in sizes up to 48" H x 46.5" W