

INSTALLATION INSTRUCTIONS FOR VLFEZHRC VISION LITE KITS

Installation Instructions for Models VLFEZHRC

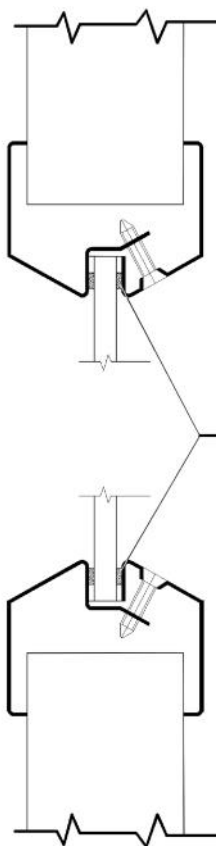

1. Read and follow the installation requirements of the door manufacturers.
2. Cut the hole in the door to correspond to the order size of the vision frame.
Assure that the opening is plumb and square.
3. Prepare the cutout if required, per the door manufacturers installation instructions.
4. Install Dow 995 caulking on both sides of polycarbonate glazing, see illustration.
5. Insert the corridor side frame in the cutout.
6. Insert glazing into frame, seating firmly, using setting blocks as needed.
7. Inserting 2 of the screws provided in the countersunk holes, carefully align the room side of the frame to the holes in the corridor side of the frame. Screw in enough to hold frame in place for alignment, then insert the other screws lightly. Tighten the screws alternately in a criss-cross pattern to avoid putting more pressure on one side than the other. Do not tighten to the point of deflecting the frame.



Florida Building Code File # FL13187

Severe Windstorm Approved Vision Lite
Tested in accordance with W/N 14475, ASTM
E330, ASTM E1886, ASTM E1996, ANSI
A250.13, TAS 203, 201, 202

Impact (ft lb) 350

Missile Level D. DP Rating (PSF) 55



Apply Dow 995 to Each Side of Glazing
(Caulking supplied by Air Louvers)



INSTALLATION INSTRUCTIONS FOR VLFEZHRC VISION LIT

**Install only glazing with the same rating as the vision
frame & door in hurricane-rated door assemblies.**

HEADQUARTERS & MFG: 9702 NEWTON AV S, BLOOMINGTON, MN 55431 PH: 800-554-6077 FAX: 952-835-2218 EMAIL: SALES@ACTIVARCPG.COM
WWW.ACTIVARCPG.COM ACPG WEST COAST (MANUFACTURING): COMMERCE CA •

ACPG WAREHOUSES: LANCASTER PA, ATLANTA GA, CHICAGO IL, DALLAS TX, FORT MYERS FL, SEATTLE WA, OMAHA NE, FARGO ND 141-301 REV B 3/2016